

4个分数的四则运算(有括号)

姓名: _____

日期: _____ 分数: _____

$$18\left(\frac{1}{6} - \frac{1}{3}\right) \div 6 =$$

$$\frac{3}{4} - \frac{1}{4}\left(\frac{3}{5} + \frac{1}{6}\right) =$$

$$50\left(\frac{3}{2} - \frac{1}{2}\right) \div 10 =$$

$$(16 \div 4 - \frac{1}{3}) \times \frac{1}{6} =$$

$$(24 \div 4 + \frac{3}{2}) \times \frac{1}{5} =$$

$$40\left(\frac{1}{4} - \frac{1}{5}\right) \div 8 =$$

$$10\left(\frac{1}{2} - \frac{1}{3}\right) \div 10 =$$

$$3\left(\frac{1}{6} + \frac{1}{3}\right) \div 1 =$$

$$(30 \div 5 - \frac{3}{2}) \times \frac{1}{2} =$$

$$\left(\frac{1}{2} + \frac{1}{6}\right) \times \frac{1}{5} - \frac{3}{4} =$$

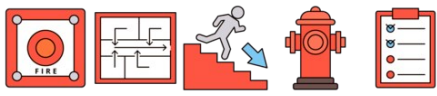

4个分数的四则运算(有括号)

姓名: _____

日期: _____ 分数: _____

$$18\left(\frac{1}{6} - \frac{1}{3}\right) \div 6 = \left(-\frac{1}{2}\right)$$

$$\frac{3}{4} - \frac{1}{4}\left(\frac{3}{5} + \frac{1}{6}\right) = \frac{67}{120}$$

$$50\left(\frac{3}{2} - \frac{1}{2}\right) \div 10 = 5$$

$$\left(16 \div 4 - \frac{1}{3}\right) \times \frac{1}{6} = \frac{11}{18}$$

$$\left(24 \div 4 + \frac{3}{2}\right) \times \frac{1}{5} = \frac{3}{2} = 1\frac{1}{2}$$

$$40\left(\frac{1}{4} - \frac{1}{5}\right) \div 8 = \frac{1}{4}$$

$$10\left(\frac{1}{2} - \frac{1}{3}\right) \div 10 = \frac{1}{6}$$

$$3\left(\frac{1}{6} + \frac{1}{3}\right) \div 1 = \frac{3}{2} = 1\frac{1}{2}$$

$$\left(30 \div 5 - \frac{3}{2}\right) \times \frac{1}{2} = \frac{9}{4} = 2\frac{1}{4}$$

$$\left(\frac{1}{2} + \frac{1}{6}\right) \times \frac{1}{5} - \frac{3}{4} = \left(-\frac{37}{60}\right)$$